



630/28 Bonar Street Arncliffe NSW

2 2 1

Positioned on Level 6 of the renowned Fusion complex in Arncliffe, this bright spacious two-bedroom apartment incorporates both enjoyable living with privacy and sophisticated interior which sets high standard of luxury apartment living in Arncliffe with resort style facilities including pool, spa, sauna, gym, BBQ facility, on-site Building Manager and Surveillance CCTV System which are exclusively available to the residents of "Fusion" complex.

Centrally located only 10 kilometres from Sydney CBD, it is surrounded by local shops, cafes, restaurants. Arncliffe, Turrella and Wolli Creek train stations are all within walking distance.

[For full version visit the website](#)

Type : Apartment

View : <https://www.onespaceproperty.com.au/sale/nsw/s-t-george/arncliffe/residential/apartment/7136455>



John (junjie) Zhu
0292678810

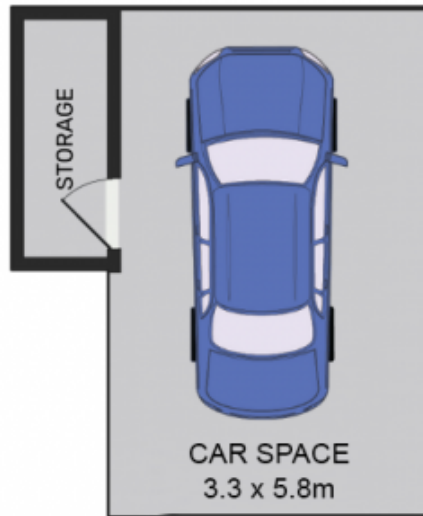
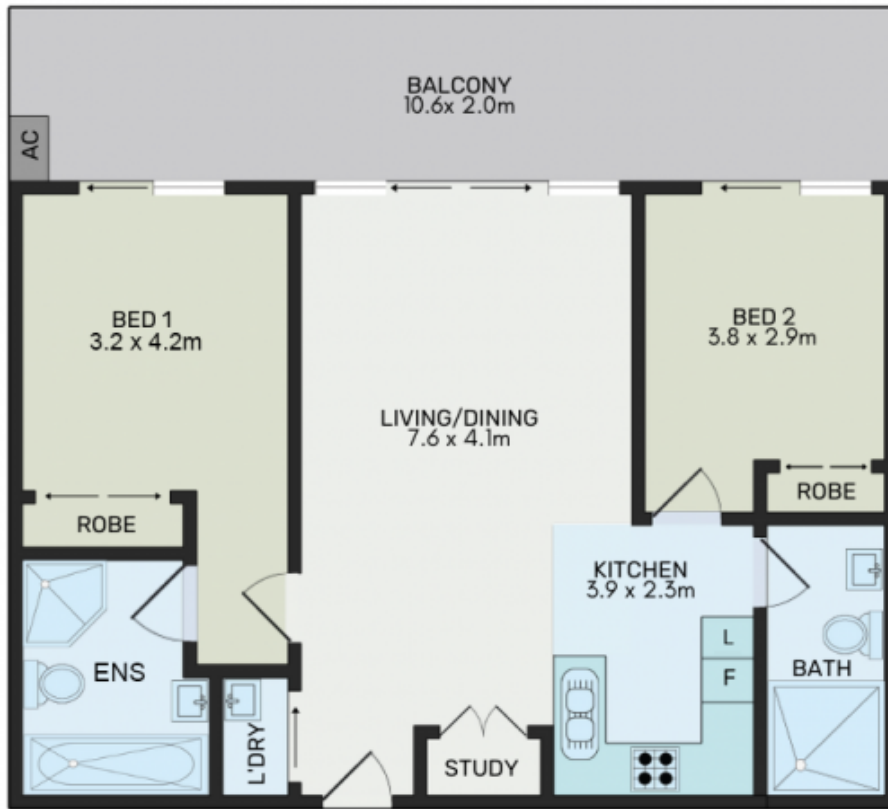

All information contained herein is gathered from all sources we believed to be reliable. However we cannot guarantee its accuracy and interested parties should rely on their own inquiries.

630/28 Bonar St Arncliffe