



522/14 Baywater Drive WENTWORTH POINT NSW

2 1 1

TWO BEDROOMS, TWO BATHROOM APARTMENT WITH EXCELLENT FLOOR PLAN LOCATED ON LEVEL 5 IN MESSINA BUILDING WITH PRIVATE VIEWS OF MESSINA OUTDOOR SWIMMING POOL AND GARDENS FROM THE BALCONY AND MAIN BEDROOM

**Type** : Apartment

**Price** : \$ 600,000

**View** : <https://www.onespaceproperty.com.au/sale/nsw/inner-west/wentworth-point/residential/apartment/7136461>

FEATURES TWO LARGE BEDROOMS SEPERATED BY THE LOUNGE/DINING ROOM AND OPEN PLANNED GAS KITCHEN WITH LARGE ISLAND STONE BENCH TOP.

THE MAIN BEDROOM HAS WALK IN ROBES AND ENSUITE BATHROOM. ADD THE SPLIT AIR CONDITIONER, INTERNAL LAUNDRY, SECURITY CAR

[For full version visit the website](#)



**John (junjie) Zhu**  
0292678810

FLOOR PLAN

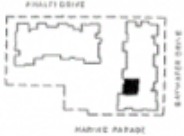

LOCATION

**UNIT 522**  
**2 BEDROOM**

INTERNAL	64 sqm
BALCONY	18 sqm
TOTAL AREA	102 sqm

KEY:

- 1 Entry
- 2 Living
- 3 Dining
- 4 Kitchen
- 5 Bedroom 1
- 6 Bedroom 2
- 7 Wardrobe
- 8 Bathroom
- 9 Ensuite
- 10 Laundry
- 11 Store
- 12 Balcony

28.10.2010  
REV. D

