



1501/46 Savona Drive WENTWORTH POINT NSW

2 2 1

Quality lifestyle Awaits - a chic, cleverly & immaculately designed apartments with elevated podium courtyard and plenty of lush, private spaces for the exclusive use of Taiga residents and their guests.

Type : Apartment

View : <https://www.onespaceproperty.com.au/lease/nsw/inner-west/wentworth-point/residential/apartment/7137150>

Perfectly positioned between Sydneys harbour foreshore and the surrounding parklands.

Taiga is one of the final stages in this stunning Wentworth Point community.

Facilities include a stunning rooftop pool, relaxing music

[For full version visit the website](#)

the ADDRESS

WENTWORTH POINT

TAIGA

APARTMENT A15.01

2 Bed/2 Bath

Internal Area 80 sqm
 External Area 11 sqm
 Total Area 91 sqm

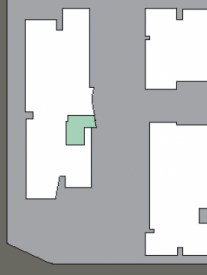

Level 15



KEY

- 01 Entry
- 02 Living
- 03 Dining
- 04 Kitchen
- 05 Bathroom
- 06 Laundry
- 07 Balcony
- 08 Robe
- 09 Store
- 10 Bedroom 1
- 11 Bedroom 2
- 12 Ensuite

1800 333 818

TheAddressApartments.com.au



Revision 02 5/05/15

Disclaimer: The particulars are set out as a general outline for the guidance of intending purchasers and do not constitute an offer or contract. All descriptions, dimensions, measurements, references to conditions and necessary permissions for use and other details are given in good faith and the purchaser is advised to verify all the particulars with the relevant authorities. The purchaser is advised to seek professional advice in relation to each term, and where necessary seek advice. No third party supplier or their agents has any authority to make or give any representations or warranty in relation to this property. External areas may be larger for courtyard apartments. Refer to the detailed area schedule.