



C422/46 Savona Drive WENTWORTH POINT NSW

1 1 1

Quality lifestyle Awaits - a chic, cleverly & immaculately designed apartments with elevated podium courtyard and plenty of lush, private spaces for the exclusive use of Taiga residents and their guests.

Perfectly positioned between Sydneys harbour foreshore and the surrounding parklands.

Taiga is one of the final stages in this stunning Wentworth Point community.

Facilities include a stunning rooftop pool, relaxing music

[For full version visit the website](#)

Type : Apartment

View : <https://www.onespaceproperty.com.au/lease/nsw/inner-west/wentworth-point/residential/apartment/7137177>

the
ADDRESS
WENTWORTH POINT

TAIGA

APARTMENT C4.22

1 Bed/1 Bath

Internal Area 54 sqm
External Area 5 sqm
Total Area 59 sqm

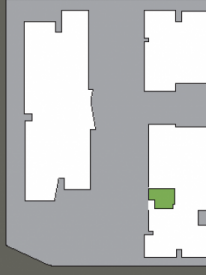

Level 4
0 2



KEY

- 01 Entry
- 02 Living
- 03 Dining
- 04 Kitchen
- 05 Bathroom
- 06 Laundry
- 07 Balcony
- 08 Robe
- 09 Store
- 10 Bedroom

1800 333 818
TheAddressApartments.com.au



Revision 02 5/05/15

Disclaimer: The particulars are set out as a general outline for the guidance of intending purchasers and do not constitute an offer or contract. All descriptions, dimensions, references to conditions and necessary permissions for use and other details are given in good faith and are believed to be correct, but the purchaser should not rely on these particulars. The purchaser should not rely on the statements, representations, warranties, conditions, covenants, or other terms, and where necessary seek advice. No third party supplier or their agents has any authority to make or give any representations or warranty in relation to this property. External areas may be larger for courtyard apartments. Refer to the detailed area schedule.