



55/188-190 Balaclava Road Marsfield NSW

3 2 2

Exuding a welcoming ambiance, this renovated full brick apartment unveils an impressive open plan design with tree top views promising easy relaxation.

Well presented for instant enjoyment, the home offers generous dimensions capturing light from both sides and a comfortable design for a relaxed easycare lifestyle.

Of ultimate convenience, it's across the road from Woolworths and Macquarie University, plus just moments to city buses, the Metro, Macquarie Centre, Epping Boys High School, Macquarie University Hospital and local parks.

**Type** : Apartment

**View** : <https://www.onespaceproperty.com.au/lease/nsw/northern-suburbs/marsfield/residential/apartment/8114778>



**Sharon (si) Shen**  
0292678810

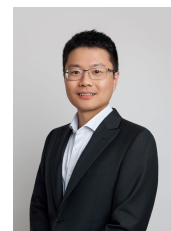

**Kevin Jingxian Zhao**  
0427763979

[For full version visit the website](#)

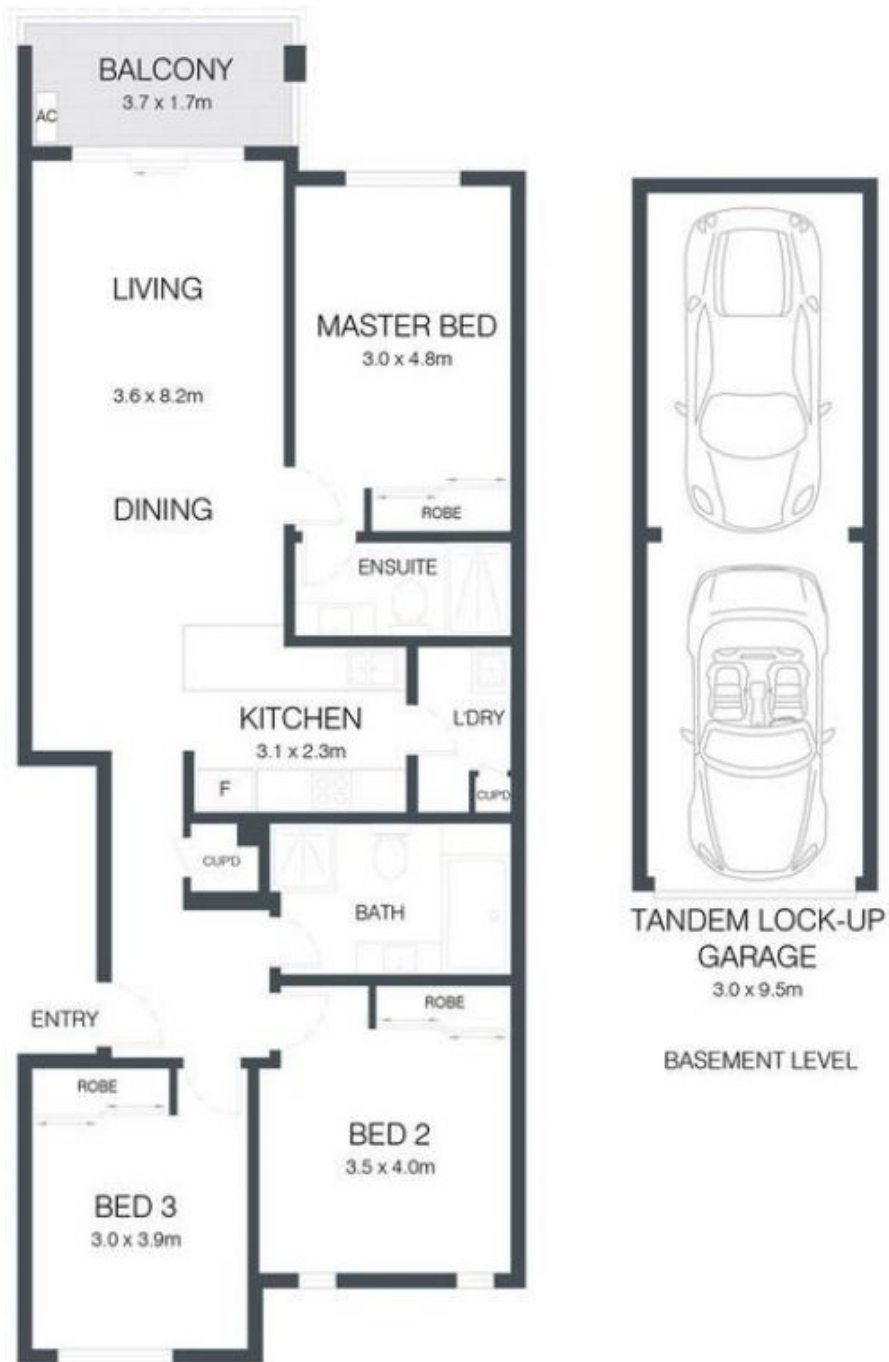

LEVEL TWO

Internal area 105sqm approx.  
 Parking area 34sqm approx.  
 Total area 139sqm approx.



55/188-190 BALACLAVA ROAD, MARSFIELD



Scale in metres, Indicative only. Dimensions are approximate.

All information contained here is gathered from sources we believe to be reliable.

However, we cannot guarantee its accuracy, and interested persons should rely on their enquiries.