

1502/13 Verona Drive Wentworth Point NSW

1 1 1

Set amid lush parklands and the serene waters of Homebush Bay, this contemporary one-bedroom luxury apartment is located in the prestigious "Savannah" complex. Residents enjoy a wealth of resort-style amenities, including a state-of-the-art gym, a refreshing indoor swimming pool, BBQ facilities, and the convenience of an onsite building manager.

Positioned on the 15th floor, this stunning apartment provides sweeping views of the Parramatta River, stretching all the way to the Sydney CBD. The open-concept layout ensures that these spectacular vistas can be appreciated from every area of the home. Whether you're enjoying a leisurely breakfast in the dining space,

[For full version visit the website](https://www.onespaceproperty.com.au)

**Type** : Apartment  
**Building Size** : 80 sqm  
**View** : <https://www.onespaceproperty.com.au/sale/nsw/inner-west/wentworth-point/residential/apartment/8131224>



**John (junjie) Zhu**  
0292678810



**Elaine Chu**  
0292678810

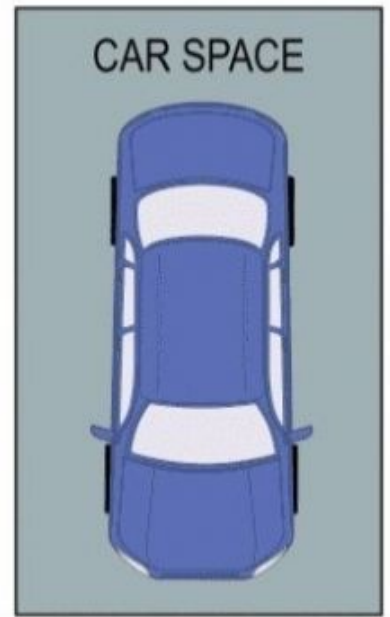
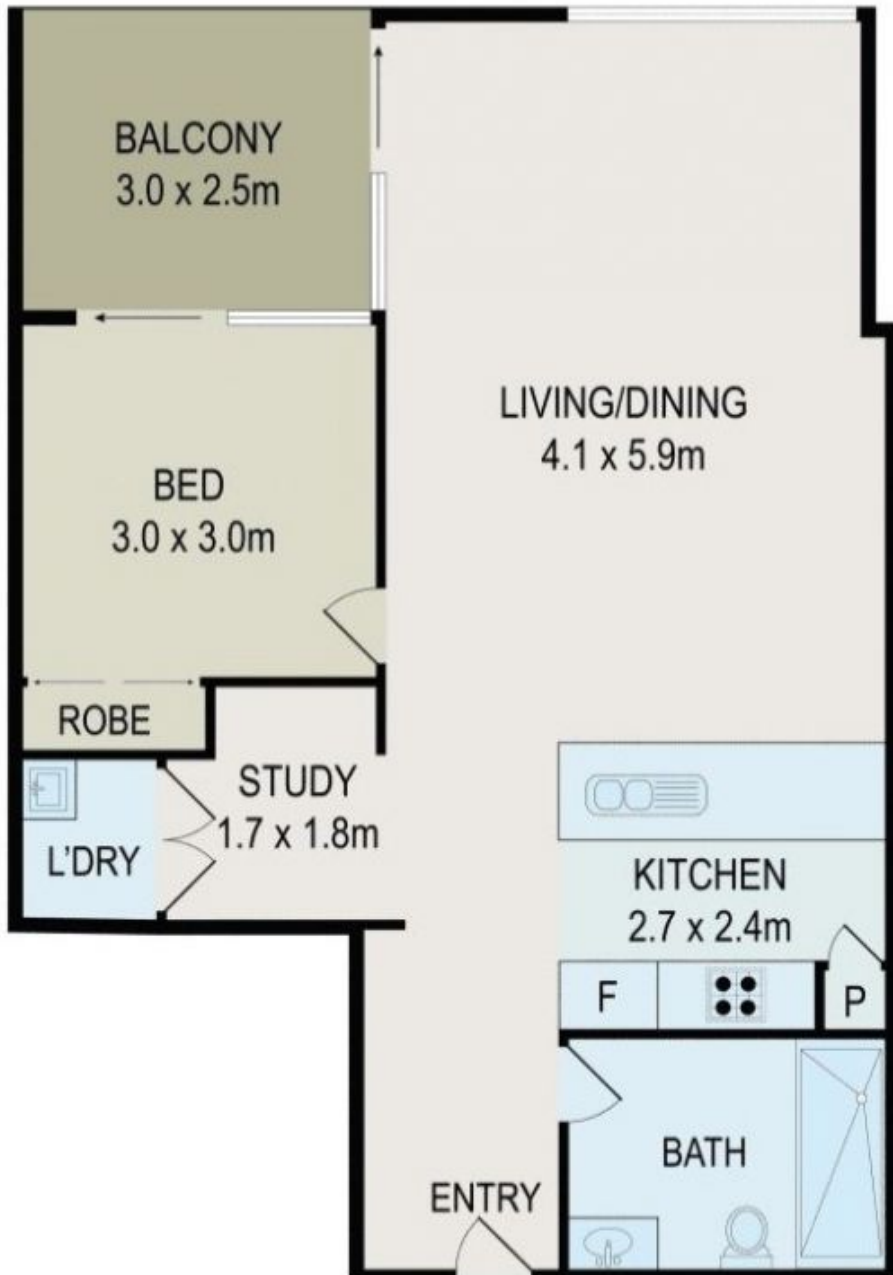

All information contained herein is gathered from all sources we believe to be reliable. However we cannot guarantee its accuracy and interested parties should rely on their own enquiries.



**1502/13 Verona Drive, Wentworth Point, NSW, 2127**