



202/169-175 Phillip Street Waterloo NSW

2 2 1

Setting a new standard for inner-city living, this stylish dual-level apartment is located in the highly sought-after 'Warehouse 5' complex on the vibrant Danks Street strip. Perfectly positioned for ultimate convenience, it offers direct access to an array of cafés, popular eateries, Coles and Aldi supermarkets, with Green Square and Redfern train stations just a short stroll away. Public transport is at your doorstep, and you'll enjoy close proximity to Moore Park, Centennial Parklands, and the Crown Street dining precinct.

Designed for effortless modern living and entertaining, this sunny east to west aspect apartment is bathed in natural light and features a generous open-plan layout with sleek

[For full version visit the website](https://www.onespaceproperty.com.au)

Type : Apartment

View : <https://www.onespaceproperty.com.au/lease/nsw/eastern-suburbs/waterloo/residential/apartment/8347873>



Charles (lei) Cheng
0292678810

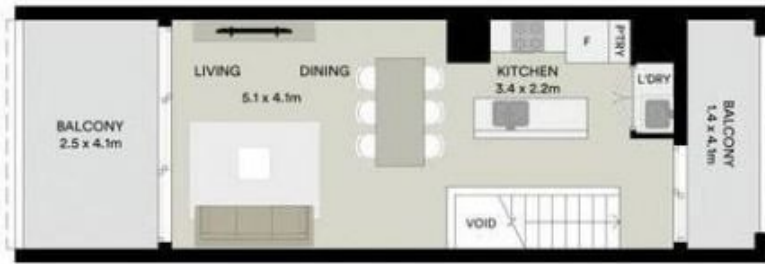

UPPER LEVEL



ENTRY LEVEL

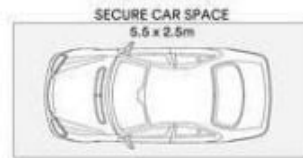

BASEMENT



All information contained in this document is from sources we believe to be accurate, however we cannot guarantee its accuracy. Interested persons should make and rely on their own enquiries in relation to measurements, dimensions, layout, furniture and descriptions.