



## 603/500 Pacific Highway St Leonards NSW

1 1 1

Welcome to The Landmark-an architectural icon in the heart of Northshore, where sophisticated design meets unrivalled convenience. This beautifully appointed one bedroom plus study apartment is just steps from buzzing cafes, fine dining, boutique shopping, and the Metro station, putting the CBD, Chatswood, Crows Nest, Martin Place, and Barangaroo within easy reach.

Thoughtfully designed with high-end finishes and timeless style, it offers more than just a home-it's a lifestyle. Indulge in exclusive amenities including a heated indoor pool, spa, sauna, yoga studio, golf simulator, private cinema, and 24-hour concierge.

[For full version visit the website](https://www.onespaceproperty.com.au)

**Type** : Apartment  
**Price** : \$ 935,000  
**Building Size** : 93 sqm  
**View** : <https://www.onespaceproperty.com.au/sale/nsw/north-shore-lower/st-leonards/residential/apartment/8359863>



**John (junjie) Zhu**  
0292678810

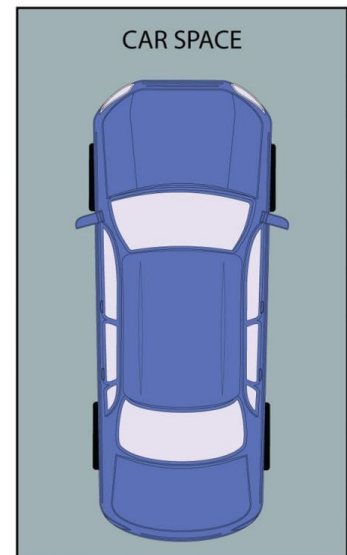
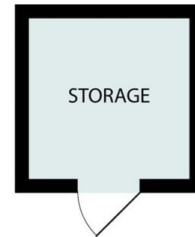
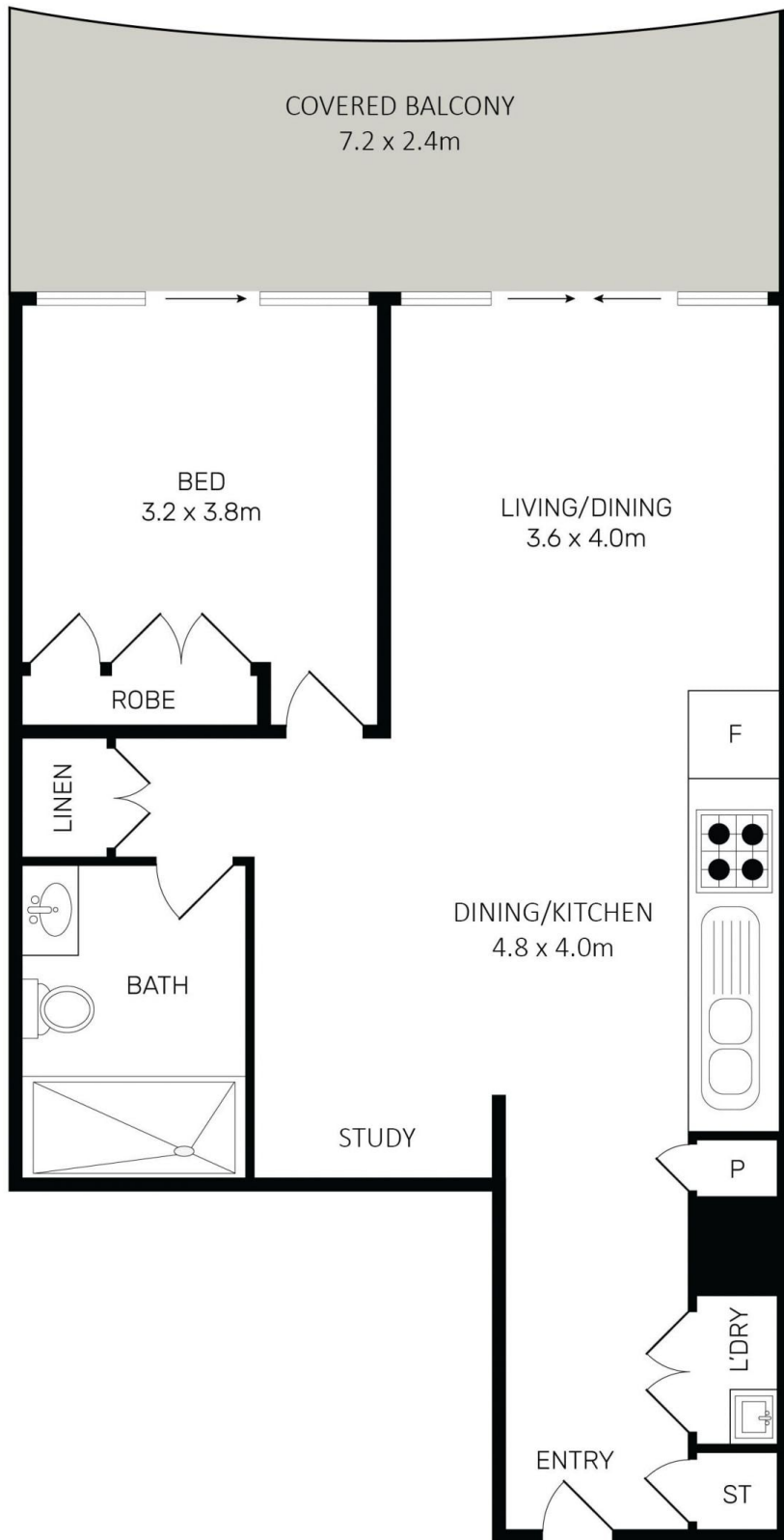

All information contained herein is gathered from all sources we believe to be reliable. However we cannot guarantee its accuracy and interested parties should rely on their own enquiries.



**603/500 Pacific Highway, St Leonards**