

## 608/13 Verona Drive Wentworth Point NSW

1 1 1

Discover contemporary luxury in this beautifully appointed one-bedroom plus study apartment, perfectly positioned on the 6th floor of the renowned "Savannah" complex. Designed for comfort and style, this residence enjoys a desirable north-west aspect, bathing the interiors in natural light throughout the day.

Residents of "Savannah" enjoy exclusive access to a range of resort-style amenities, including a fully equipped gym, indoor swimming pool, BBQ facilities, and the convenience of an onsite Building Manager ensuring day-to-day ease of living.

Located in the heart of Wentworth Point, everything you

[For full version visit the website](https://www.onespaceproperty.com.au)

**Type** : Apartment  
**Price** : \$ 610,000  
**Building Size** : 86 sqm  
**View** : <https://www.onespaceproperty.com.au/sale/nsw/inner-west/wentworth-point/residential/apartment/8534075>



**John (junjie) Zhu**  
0292678810

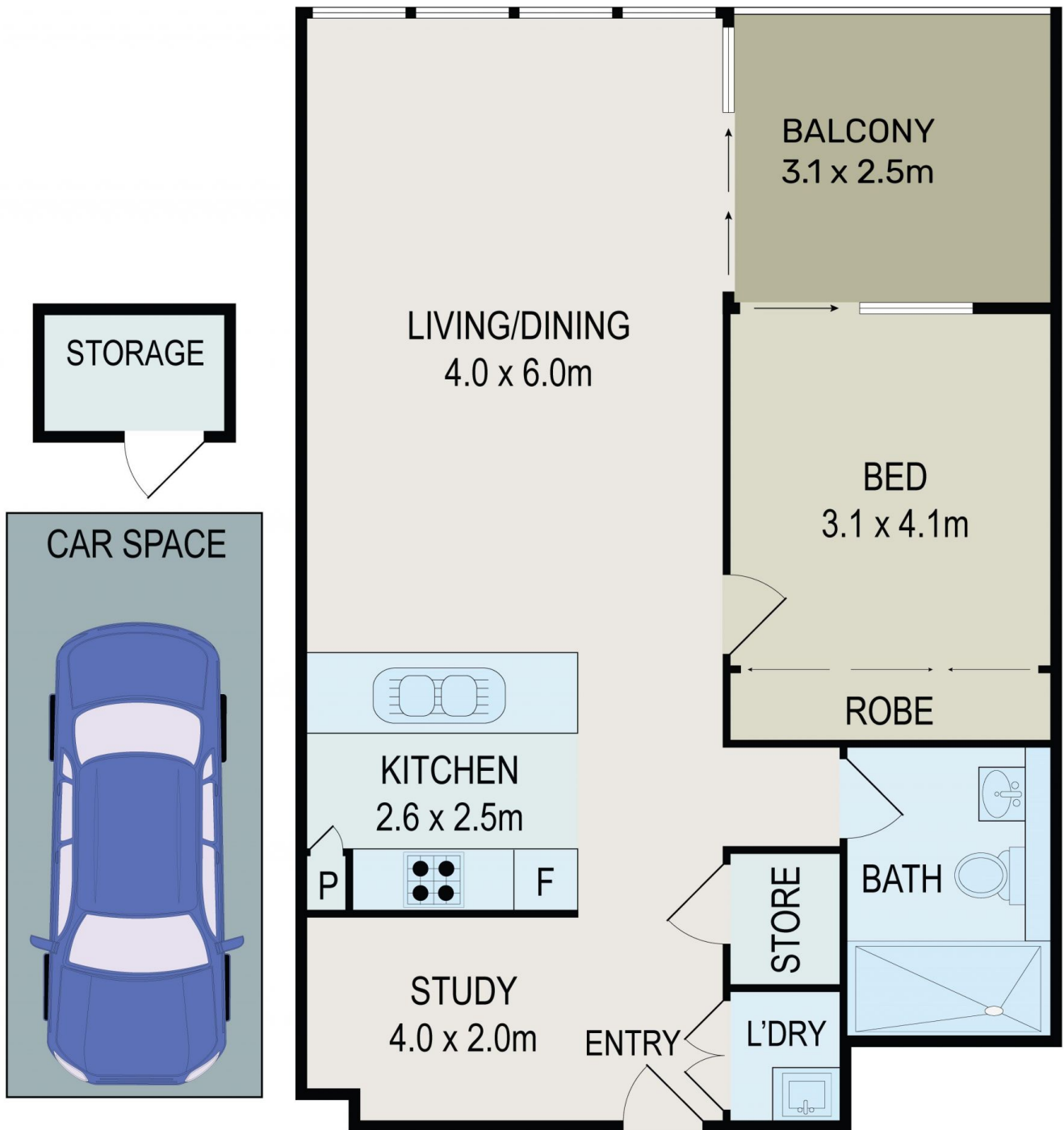

All information contained herein is gathered from all sources we believe to be reliable. However we cannot guarantee its accuracy and interested parties should rely on their own enquiries.



**608/13 VERONA DRIVE, WENTWORTH POINT**