

703/301 Botany Road Zetland NSW

2 2 1

Designed by the award-winning architect Koichi Takada, this fully furnished 2-bedroom apartment in the renowned Infinity by Crown Group offers a luxury living experience in one of Zetland's most sought-after addresses. Thoughtfully appointed with quality finishes and stylish furnishings, this residence provides contemporary comfort and an enviable lifestyle, perfectly positioned above Green Square train station and the vibrant town centre.

Apartment Features:

- ? Spacious open-plan living and dining with abundant natural light
- ? Gourmet kitchen with stone benchtops and premium

[For full version visit the website](https://www.onespaceproperty.com.au/lease/nsw/eastern-suburbs/zetland/residential/apartment/8555869)

Type : Apartment
View : <https://www.onespaceproperty.com.au/lease/nsw/eastern-suburbs/zetland/residential/apartment/8555869>



Rebecca Sun
0292678810

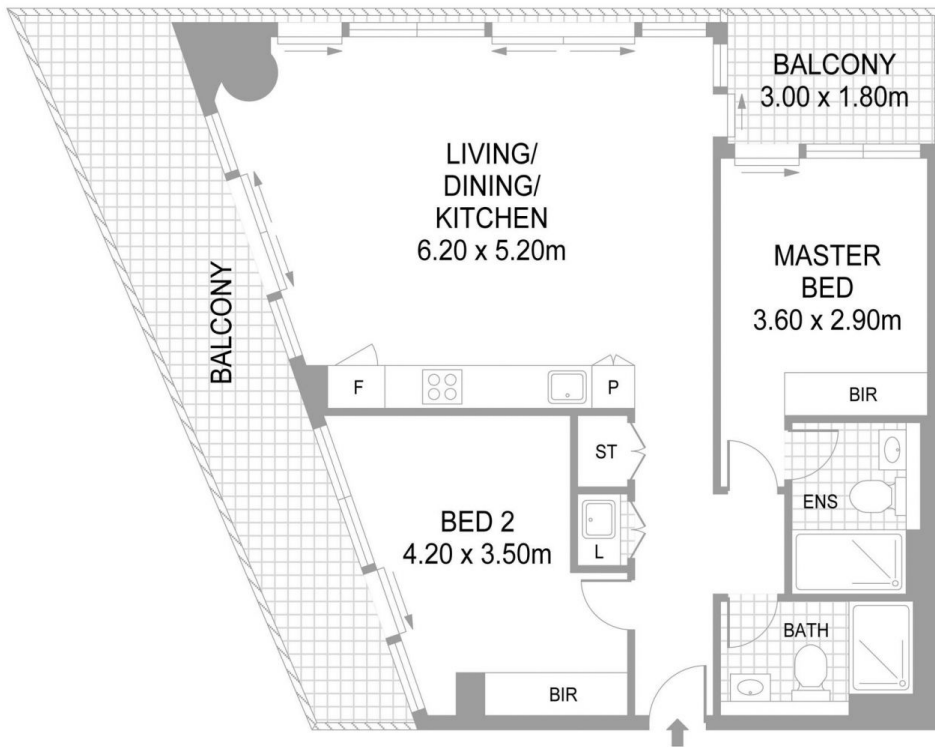

Internal Area	77sqm
Balcony Area	23sqm
Car Space Area	14sqm
Storage Cage Area	1sqm
Total Area	115sqm

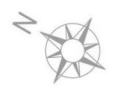
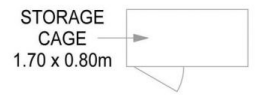

703/301 BOTANY RD, ZETLAND

Disclaimer; Please note that while the information contained in this floor plan is provided by reliable sources, we cannot guarantee its accuracy. It is intended as a guide only. Interested parties should rely on their own enquiry. Drawing not to scale. Dimensions are approximate.