

322/7 Verona Drive Wentworth Point NSW

1 1 1

Located in the vibrant Wentworth Point community, this apartment is just moments from an array of local amenities. Enjoy the convenience of being steps away from waterfront cafes, restaurants, shops, and schools. The area also boasts exceptional recreational facilities, including scenic cycling paths, lush parks, and easy access to Sydney Olympic Park. With the Bennelong Bridge connecting to Rhodes, commuting and exploring Sydney is effortless.

Apartment Features:

? Light-Filled Living: North-facing design captures natural light, creating a warm and inviting atmosphere throughout the day.

? Outdoor Entertaining: Generous 25 sqm courtyard with

[For full version visit the website](https://www.onespaceproperty.com.au)

Type : Apartment
Building Size : 96 sqm
View : <https://www.onespaceproperty.com.au/ease/nsw/inner-west/wentworth-point/residential/apartment/8565542>



Sharon (si) Shen
0292678810

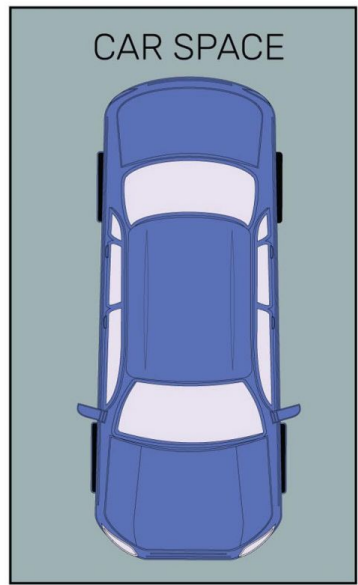
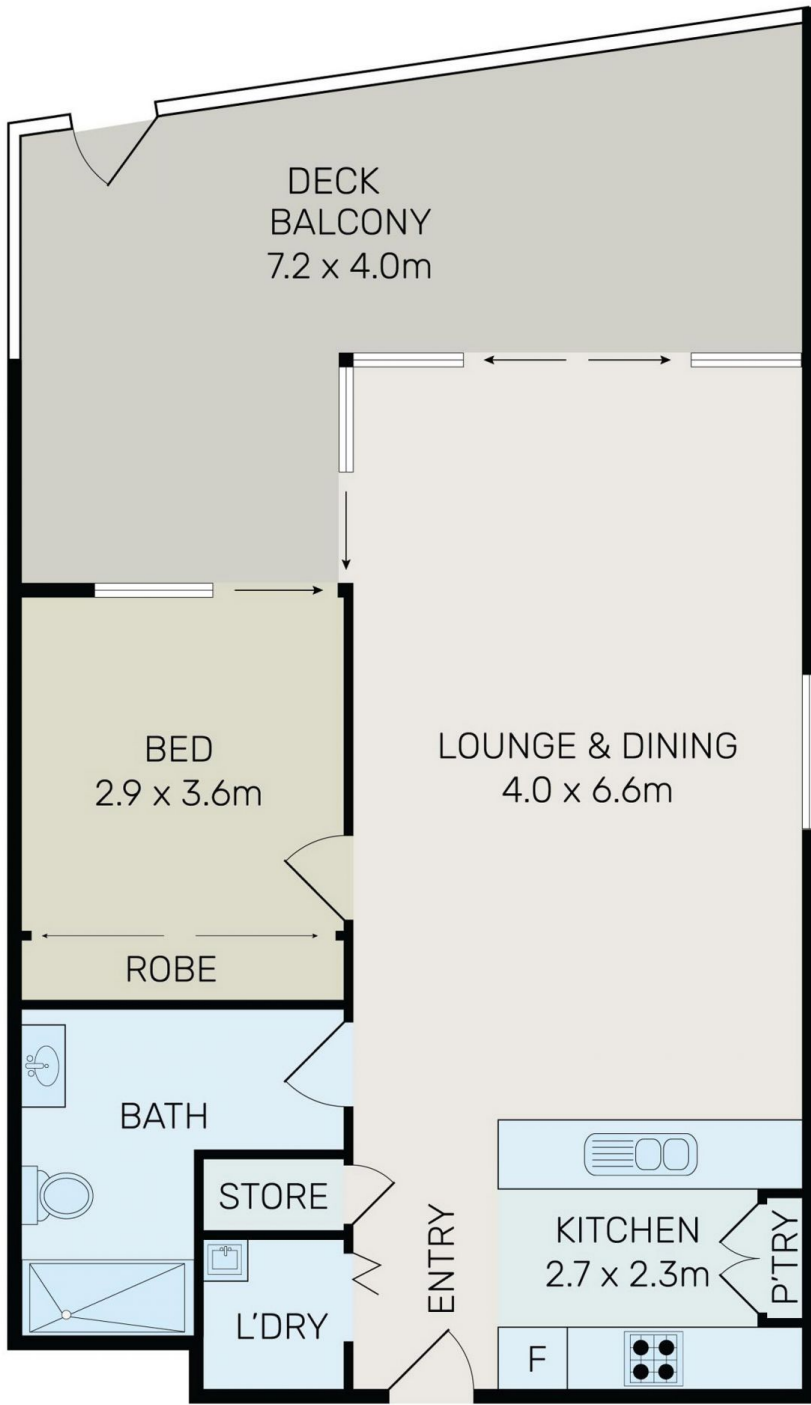

All information contained herein is gathered from all sources we believe to be reliable. However we cannot guarantee its accuracy and interested parties should rely on their own enquiries.



322/46 Savona Drive, Wentworth Point