



510/13 Verona Drive Wentworth Point NSW

2 2 1

Perfectly positioned just footsteps from the very best of Wentworth Point, this contemporary two-bedroom residence combines luxury modern finishes with the warm, cosy comfort of a truly spacious home. Enjoy ultimate convenience with Marina Square Shopping Centre, Wentworth Point Public School, local cafés, restaurants, shops, bus services, the ferry wharf and Bennelong Bridge all within easy walking distance-offering a seamless link to Rhodes and beyond.

Located only 18 kilometres from Sydney CBD, this private Level 5 apartment is set within the iconic "Savannah" complex and enjoys access to outstanding resort-style facilities including a fully equipped gym, indoor swimming

[For full version visit the website](https://www.onespaceproperty.com.au)

Type : Apartment
Price : \$700,000 To \$730,000
Building Size : 105 sqm
View : <https://www.onespaceproperty.com.au/sale/nsw/inner-west/wentworth-point/residential/apartment/8601889>



John (junjie) Zhu
0292678810

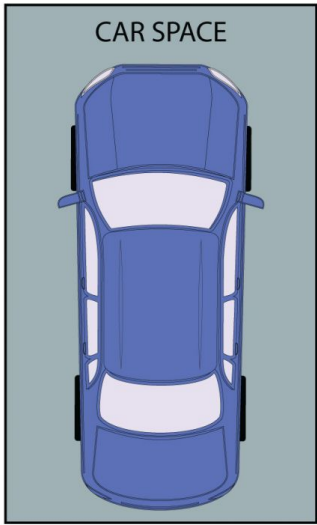
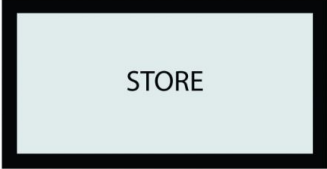
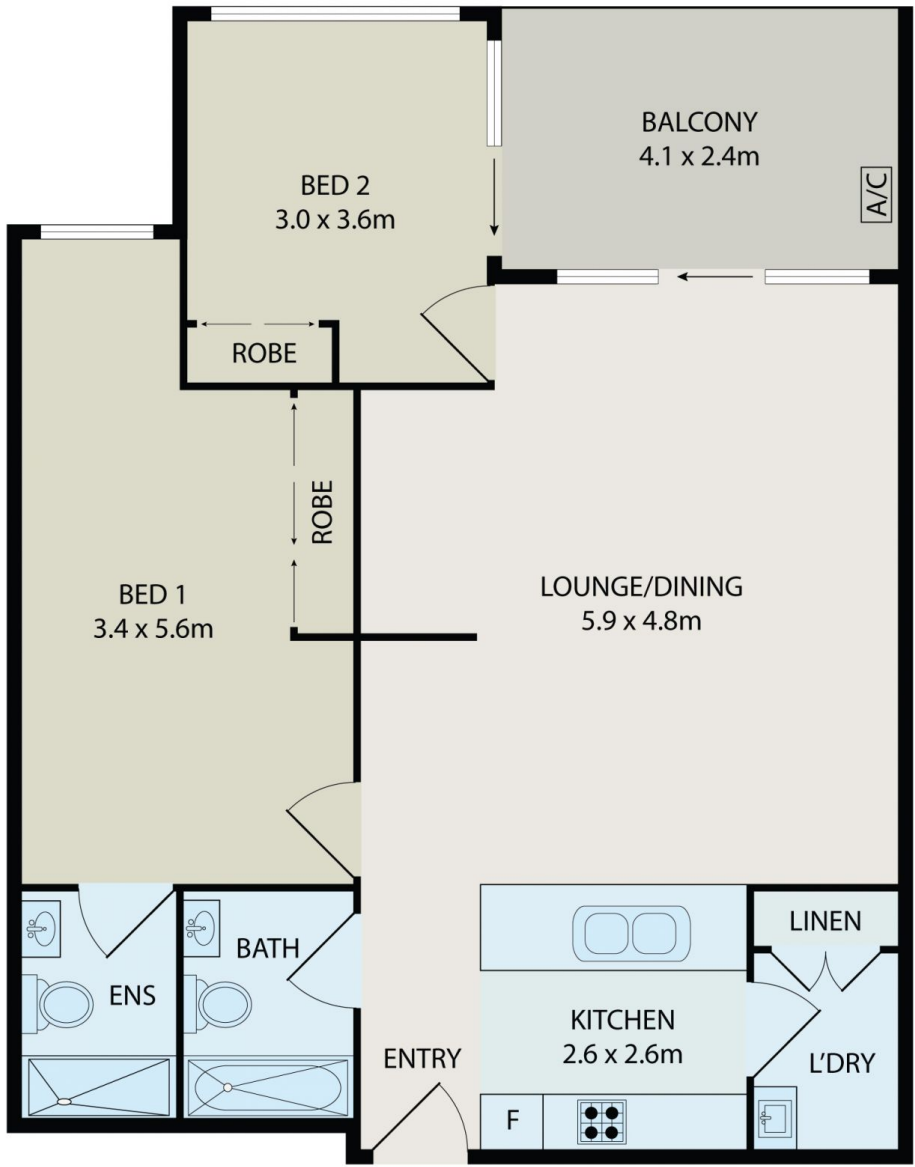

All information contained herein is gathered from all sources we believe to be reliable. However we cannot guarantee its accuracy and interested parties should rely on their own enquiries.



510/13 Verona Drive, Wentworth Point